

Section properties										Safe load tables										
										Le (m)	Safe working loads in kg		Def. limit	Def. limit	Safe working loads in kg		Def. limit	Def. limit	Safe column loads kg at centroid	Safe column loads kg at face
Load	Def.	span/200 (kg)	span/360 (kg)	Load	Def.	span/200 (kg)	span/360 (kg)													
Area	Wt	lxx	Zxx	Zxx	rxx	lyy	Zyy	ryy	0.6	237	2.64	237	150	118	2.11	118	93	2978	894	
cm ²	kg/m	cm ⁴	(top)	(btm)	cm	cm ⁴	cm ³	cm	0.7	203	3.59	198	110	101	2.87	101	69	2471	821	
			cm ³	cm ³					0.8	177	4.68	151	84	89	3.75	89	53	2019	747	
2.35	1.85	1.21	1.00	1.43	0.72	5.44	2.63	1.52	0.9	158	5.94	120	66	79	4.75	75	42	1657	677	
									1.0	142	7.33	97	54	71	5.86	61	34	1375	613	
									1.1	129	8.87	80	44	65	7.09	50	28	1156	556	
									1.2	118	10.55	67	37	59	8.44	42	23	984	505	
									1.3	109	12.38	57	32	55	9.91	36	20			
									1.4	101	14.36	49	27	51	11.49	31	17			
									1.5	95	16.49	43	24	47	13.18	27	15			
									1.6	89	18.76	38	21	44	15.00	24	13			
									1.7	84	21.18	34	19	42	16.95	21	12			
									1.8	79	23.74	30	17	39	19.00	19	10			
									1.9	75	26.45	27	15	37	21.16	17	9			
									2.0	71	29.31	24	13	35	23.45	15	8			
									2.1	68	32.31	22	12	34	25.86	14	8			
									2.2	65	35.46	20	11	32	28.38	13	7			
									2.3	62	38.76	18	10	31	31.01	11	6			
									2.4	59	42.20	17	9	30	33.77	11	6			
									2.5	57	45.80	16	9	28	36.63	10	5			
									2.6	55	49.53	14	8	27	39.63	9	5			
									2.7	53	53.42	13	7	26	42.74	8	5			
									2.8	51	57.45	12	7	25	45.95	8	4			
									2.9	49	61.62	12	6	24	49.29	7	4			
									3.0	47	65.95	11	6	24	52.76	7	4			

MS2125

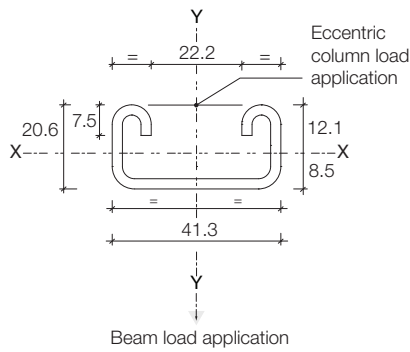

Area	Wt	lxx	Zxx	Zxx	rxx	lyy	Zyy	ryy	0.6	667	1.55	667	667	334	1.24	334	334	7582	1765
cm ²	kg/m	cm ⁴	(top)	(btm)	cm	cm ⁴	cm ³	cm	0.7	572	2.11	572	526	286	1.69	286	286	7214	1720
			cm ³	cm ³					0.8	501	2.76	501	403	250	2.21	250	250	6733	1665
4.71	3.70	5.78	2.81	2.81	1.11	10.88	5.27	1.52	0.9	445	3.50	445	318	222	2.80	222	199	6140	1601
									1.0	400	4.32	400	258	200	3.46	200	161	5484	1528
									1.1	364	5.22	364	213	182	4.17	182	133	4835	1451
									1.2	334	6.22	322	179	167	4.97	167	112	4243	1372
									1.3	308	7.29	274	152	154	5.84	154	95	3726	1295
									1.4	286	8.46	237	131	143	6.77	143	82	3284	1221
									1.5	267	9.71	206	115	133	7.77	129	72	2908	1150
									1.6	250	11.05	181	101	125	8.84	113	63	2589	1084
									1.7	236	12.47	161	89	118	9.98	100	56	2317	1022
									1.8	222	13.98	143	80	111	11.19	89	50	2084	964
									1.9	211	15.58	129	71	105	12.47	80	45	1884	910
									2.0	200	17.26	116	64	100	13.81	72	40		
									2.1	191	19.03	105	58	95	15.23	66	37		
									2.2	182	20.89	96	53	91	16.72	60	33		
									2.3	174	22.83	88	49	87	18.27	55	30		
									2.4	167	24.86	81	45	83	19.89	50	28		
									2.5	160	26.98	74	41	80	21.58	46	26		
									2.6	154	29.18	69	38	77	23.35	43	24		
									2.7	148	31.46	64	35	74	25.18	40	22		
									2.8	143	33.84	59	33	72	27.07	37	21		
									2.9	138	36.30	55	31	69	29.04	34	19		
									3.0	133	38.84	52	29	67	31.08	32	18		

MS2125-C2

(Combination comprising two MS2125)

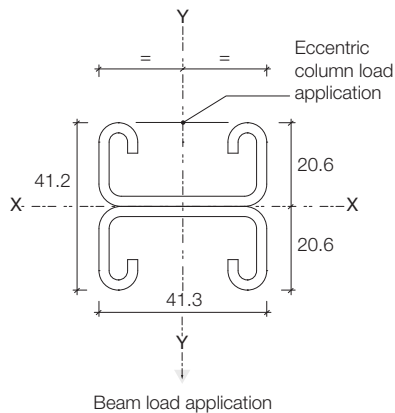

Metal framing systems

Section properties										Safe load tables																									
										Le (m)	Safe working loads in kg uniform (kg) Load		Def. limit span/200 (mm) Def.	Def. limit span/360 (kg) Def.	Safe working loads in kg concentrated (kg) Load		Def. limit span/200 (kg) Def.	Def. limit span/360 (kg) Def.	Safe column loads kg at centroid	Safe column loads kg at face															
Area	Wt	lxx	Zxx	Zxx	rxx	lyy	Zyy	ryy		0.6	0.7	0.8	0.9	1.0	1.1	1.2	1.3	1.4	1.5	1.6	1.7	1.8	1.9	2.0	2.1	2.2	2.3	2.4	2.5	2.6	2.7	2.8	2.9	3.0	$\frac{\propto Le}{r_{xx}} > 180$
cm ²	kg/m	cm ⁴	(top)	(btm)	cm	cm ⁴	cm ³	cm		523	448	392	349	314	285	261	241	224	209	196	185	174	165	157	149	143	136	131	125	121	116	112	108	105	
2.14	1.69	4.99	2.20	2.68	1.53	6.14	2.97	1.69		523	448	392	349	314	285	261	241	224	209	196	185	174	165	157	149	143	136	131	125	121	116	112	108	105	

MS4115

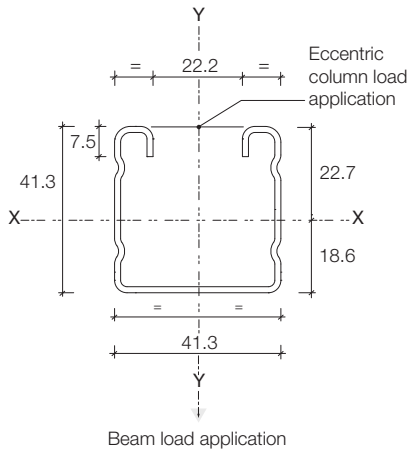

Area	Wt	lxx	Zxx	Zxx	rxx	lyy	Zyy	ryy	0.6	0.7	0.8	0.9	1.0	1.1	1.2	1.3	1.4	1.5	1.6	1.7	1.8	1.9	2.0	2.1	2.2	2.3	2.4	2.5	2.6	2.7	2.8	2.9	3.0	
cm ²	kg/m	cm ⁴	(top)	(btm)	cm	cm ⁴	cm ³	cm	1429	1225	1072	953	858	780	715	660	613	572	536	505	476	451	429	408	390	373	357	343	330	318	306	296	286	
4.29	3.38	24.82	6.01	6.01	2.41	12.27	5.94	1.69	1429	1225	1072	953	858	780	715	660	613	572	536	505	476	451	429	408	390	373	357	343	330	318	306	296	286	

MS4115-C2
(Combination comprising 2 no. MS4115)

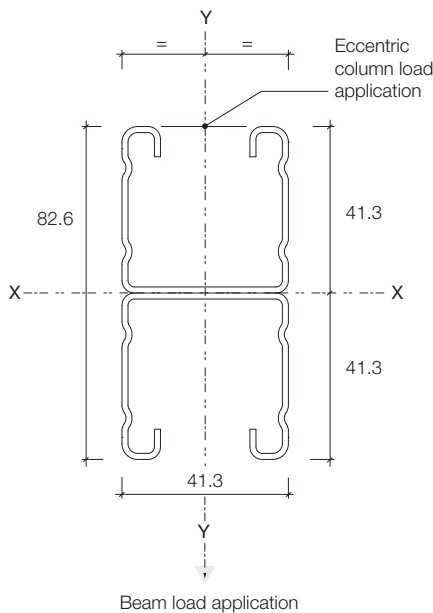

Section properties									Safe load tables																												
									Le (m)	Safe working loads in kg uniform (kg) Load		Def. limit span/200 (kg)	Def. limit span/360 (kg)	Safe working loads in kg concentrated (kg) Load		Def. limit span/200 (kg)	Def. limit span/360 (kg)	Safe column loads kg at centroid	Safe column loads kg at face																		
Area	Wt	lxx	Zxx (top)	Zxx (btm)	rxx	lyy	Zyy	ryy	0.6	0.7	0.8	0.9	1.0	1.1	1.2	1.3	1.4	1.5	1.6	1.7	1.8	1.9	2.0	2.1	2.2	2.3	2.4	2.5	2.6	2.7	2.8	2.9	3.0	$\frac{\alpha Le}{r_{xx}}$	>180		
1.52	1.20	0.89	0.75	1.03	0.77	3.68	1.78	1.55	179	153	134	119	107	97	89	82	77	71	67	63	60	56	54	51	49	47	45	43	41	40	38	37	36	35	34		
cm ²	kg/m	cm ⁴	cm ³	cm ³	cm	cm ⁴	cm ³	cm	179	153	134	119	107	97	89	82	77	71	67	63	60	56	54	51	49	47	45	43	41	40	38	37	36	35	34		

MS2115

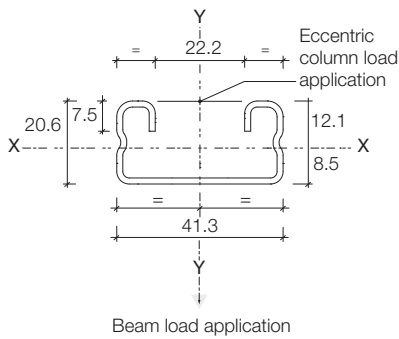

Section properties									Safe load tables																											
									Le (m)	Safe working loads in kg uniform (kg) Load		Def. limit span/200 (kg)	Def. limit span/360 (kg)	Safe working loads in kg concentrated (kg) Load		Def. limit span/200 (kg)	Def. limit span/360 (kg)	Safe column loads kg at centroid	Safe column loads kg at face																	
Area	Wt	lxx	Zxx (top)	Zxx (btm)	rxx	lyy	Zyy	ryy	0.6	0.7	0.8	0.9	1.0	1.1	1.2	1.3	1.4	1.5	1.6	1.7	1.8	1.9	2.0	2.1	2.2	2.3	2.4	2.5	2.6	2.7	2.8	2.9	3.0	$\frac{\alpha Le}{r_{yy}}$	>180	
3.03	2.40	4.08	1.98	1.98	1.16	7.35	3.56	1.56	472	404	354	314	283	257	236	218	202	189	177	166	157	149	141	129	123	118	113	109	105	101	98	94	94	94		
cm ²	kg/m	cm ⁴	cm ³	cm ³	cm	cm ⁴	cm ³	cm	472	404	354	314	283	257	236	218	202	189	177	166	157	149	141	129	123	118	113	109	105	101	98	94	94	94		

MS2115-C2

(Combination comprising 2 no. MS2115)

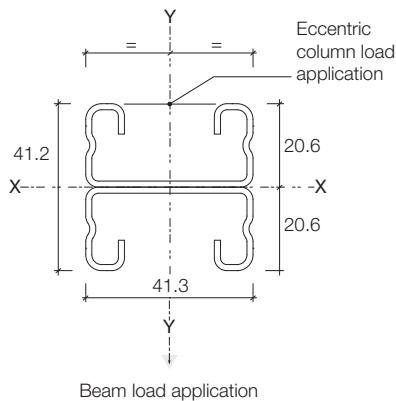

Metal framing systems

Section properties										Safe load tables										
										Le (m)	Safe working loads in kg uniform		Def. limit span/200	Def. limit span/360	Safe working loads in kg concentrated		Def. limit span/200	Def. limit span/360	Safe column loads kg at centroid	Safe column loads kg at face
Area cm ²	Wt kg/m	Ixx cm ⁴	Zxx (top) cm ³	Zxx (btm) cm ³	rx cm	Iyy cm ⁴	Zyy cm ³	ry cm	(kg) Load		(mm) Def.	(kg) (kg)	(kg) (kg)							
3.04	2.53	6.20	2.94	3.07	1.43	9.28	4.50	1.75	0.6	698	1.52	698	698	349	1.22	349	349	4541	1491	
									0.7	599	2.06	599	564	299	1.65	299	299	4151	1416	
									0.8	524	2.70	524	432	262	2.16	262	262	3701	1333	
									0.9	466	3.41	466	341	233	2.73	233	213	3250	1247	
									1.0	419	4.21	419	276	210	3.37	210	173	2842	1163	
									1.1	381	5.10	381	228	190	4.08	190	143	2521	1090	
									1.2	349	6.07	345	192	175	4.85	175	120	2229	1019	
									1.3	322	7.12	294	163	161	5.70	161	102	2011	960	
									1.4	299	8.26	254	141	150	6.60	150	88	1808	902	
									1.5	279	9.48	221	123	140	7.59	138	77	1637	849	
									1.6	262	10.78	194	108	131	8.63	121	67	1494	802	
1.7	246	12.18	172	96	123	9.74	108	60	1391	767										
1.8	233	13.65	153	85	116	10.92	96	53	1286	729										
1.9	221	15.21	138	77	110	12.17	86	48	1196	695										
2.0	210	16.86	124	69	105	13.48	78	43	1118	664										
2.1	200	18.58	113	63	100	14.86	70	39	$\frac{\propto Le}{r_{xx}} > 180$											
2.2	190	20.39	103	57	95	16.32	64	36												
2.3	182	22.29	94	52	91	17.83	59	33												
2.4	175	24.27	86	48	87	19.42	54	30												
2.5	168	26.34	80	44	84	21.07	50	28												
2.6	161	28.49	74	41	81	22.78	46	26												
2.7	155	30.72	68	38	78	24.58	43	24												
2.8	150	33.04	63	35	75	26.43	40	22												
2.9	144	35.44	59	33	72	28.35	37	21												
3.0	140	37.92	55	31	70	30.37	35	19												

MS4125 - slotted

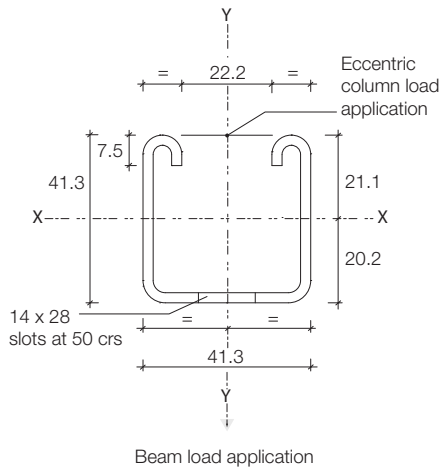

Section properties										Safe load tables										
										Le (m)	Safe working loads in kg uniform		Def. limit span/200	Def. limit span/360	Safe working loads in kg concentrated		Def. limit span/200	Def. limit span/360	Safe column loads kg at centroid	Safe column loads kg at face
Area cm ²	Wt kg/m	Ixx cm ⁴	Zxx (top) cm ³	Zxx (btm) cm ³	rx cm	Iyy cm ⁴	Zyy cm ³	ry cm	(kg) Load		(mm) Def.	(kg) (kg)	(kg) (kg)							
1.93	1.61	4.25	2.01	2.10	1.48	6.10	2.96	1.78	0.6	479	1.52	479	479	239	1.22	239	239	2930	1012	
									0.7	410	2.07	410	386	205	1.65	205	205	2691	961	
									0.8	359	2.70	359	296	180	2.16	180	180	2385	899	
									0.9	319	3.41	319	234	160	2.73	160	146	2082	836	
									1.0	287	4.21	287	189	144	3.37	144	118	1803	773	
									1.1	261	5.10	261	156	131	4.08	131	98	1564	714	
									1.2	239	6.07	237	131	120	4.81	120	82	1364	660	
									1.3	221	7.12	202	112	110	5.70	110	70	1199	611	
									1.4	205	8.26	174	97	103	6.60	103	60	1061	567	
									1.5	192	9.48	151	84	96	7.59	95	53	947	527	
									1.6	180	10.79	133	74	90	8.63	83	46	850	491	
1.7	169	12.18	118	66	84	9.74	74	41	778	463										
1.8	160	13.66	105	58	80	10.92	66	37	708	434										
1.9	151	15.21	94	52	76	12.17	59	33	$\frac{\propto Le}{r_{yy}} > 180$											
2.0	144	16.86	85	47	72	13.49	53	30												
2.1	137	18.59	77	43	68	14.87	48	27												
2.2	131	20.40	70	39	65	16.32	44	24												
2.3	125	22.30	64	36	62	17.83	40	22												
2.4	120	24.28	59	33	60	19.42	37	21												
2.5	115	26.34	55	30	57	21.07	34	19												
2.6	110	28.49	50	28	55	22.80	32	18												
2.7	106	30.72	47	26	53	24.58	29	16												
2.8	103	33.04	43	24	51	26.43	27	15												
2.9	99	35.44	41	23	50	28.35	25	14												
3.0	96	37.93	38	21	48	30.35	24	13												

MS4115 - slotted

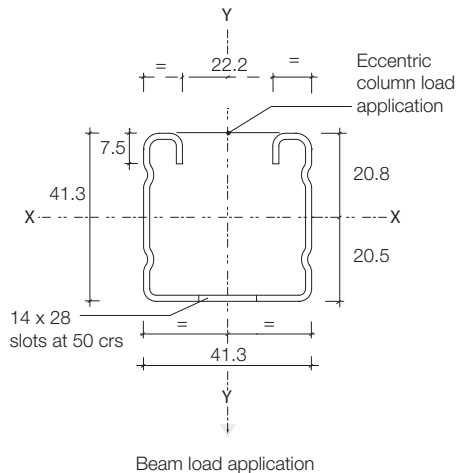

Section properties										Safe load tables										
										Le (m)	Safe working loads in kg uniform		Def. limit span/200	Def. limit span/360	Safe working loads in kg concentrated		Def. limit span/200	Def. limit span/360	Safe column loads kg at centroid	Safe column loads kg at face
Area	Wt	lxx	Zxx (top)	Zxx (btm)	rxx	lyy	Zyy	ryy	Load		Def.	Load	Def.	Load	Def.					
2.00	1.71	0.99	0.91	1.02	0.70	5.28	2.56	1.62	0.6	216	2.94	216	123	108	2.36	108	77	2490	841	
									0.7	186	4.00	162	90	93	3.20	93	56	2052	764	
									0.8	162	5.22	124	69	81	4.17	78	43	1671	688	
									0.9	144	6.61	98	55	72	5.29	61	34	1368	617	
									1.0	130	8.16	80	44	65	6.53	50	28	1134	555	
									1.1	118	9.87	66	37	59	7.90	41	23	953	499	
									1.2	108	11.74	55	31	54	9.40	35	19	810	451	
									1.3	100	13.78	47	26	50	11.02	29	16			
									1.4	93	15.98	41	23	46	12.79	25	14			
									1.5	87	18.35	35	20	43	14.68	22	12			
									1.6	81	20.88	31	17	41	16.70	19	11			
									1.7	76	23.57	28	15	38	18.85	17	10			
									1.8	72	26.42	25	14	36	21.15	15	9			
									1.9	68	29.44	22	12	34	23.55	14	8			
									2.0	65	32.62	20	11	32	26.10	12	7			
									2.1	62	35.97	18	10	31	28.77	11	6			
									2.2	59	39.47	16	9	30	31.58	10	6			
									2.3	56	43.14	15	8	28	34.51	9	5			
									2.4	54	46.98	14	8	27	37.58	9	5			
									2.5	52	50.97	13	7	26	40.78	8	4			
									2.6	50	55.13	12	7	25	44.11	7	4			
									2.7	48	59.45	11	6	24	47.56	7	4			
									2.8	46	63.94	10	6	23	51.15	6	4			
									2.9	45	68.59	9	5	22	54.87	6	3			
									3.0	43	73.40	9	5	22	58.73	6	3			

MS2125 - slotted

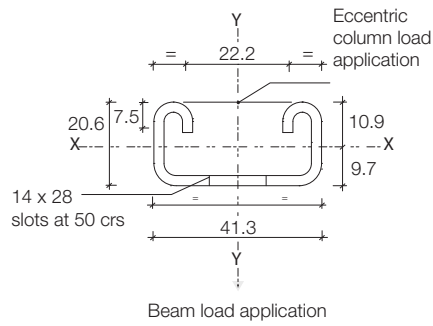

$\frac{\propto Le}{r_{xx}} > 180$

Section properties										Safe load tables										
										Le (m)	Safe working loads in kg uniform		Def. limit span/200	Def. limit span/360	Safe working loads in kg concentrated		Def. limit span/200	Def. limit span/360	Safe column loads kg at centroid	Safe column loads kg at face
Area	Wt	lxx	Zxx (top)	Zxx (btm)	rxx	lyy	Zyy	ryy	Load		Def.	Load	Def.	Load	Def.					
1.31	1.12	0.74	0.70	0.75	0.75	3.64	1.76	1.67	0.6	166	3.01	165	92	83	2.41	83	57	1738	632	
									0.7	142	4.09	121	67	71	3.28	71	42	1469	577	
									0.8	124	5.35	93	52	62	4.28	58	32	1215	521	
									0.9	110	6.77	73	41	55	5.41	46	25	1003	468	
									1.0	99	8.35	59	33	50	6.68	37	21	836	420	
									1.1	90	10.11	49	27	45	8.09	31	17	704	378	
									1.2	83	12.03	41	23	41	9.63	26	14	600	341	
									1.3	76	14.12	35	20	38	11.29	22	12	516	309	
									1.4	71	16.37	30	17	35	13.09	19	11			
									1.5	66	18.79	26	15	33	15.04	17	9			
									1.6	62	21.38	23	13	31	17.10	15	8			
									1.7	58	24.14	21	11	29	19.32	13	7			
									1.8	55	27.06	18	10	28	21.64	11	6			
									1.9	52	30.15	16	9	26	24.12	10	6			
									2.0	50	33.41	15	8	25	26.73	9	5			
									2.1	47	36.83	13	7	24	29.47	8	5			
									2.2	45	40.42	12	7	23	32.35	8	4			
									2.3	43	44.18	11	6	22	35.34	7	4			
									2.4	41	48.11	10	6	21	38.49	6	4			
									2.5	40	52.20	10	5	20	41.77	6	3			
									2.6	38	56.46	9	5	19	45.17	5	3			
									2.7	37	60.89	8	5	18	48.70	5	3			
									2.8	35	65.48	8	4	18	52.39	5	3			
									2.9	34	70.24	7	4	17	56.19	4	2			
									3.0	33	75.17	7	4	17	60.13	4	2			

MS2115 - slotted

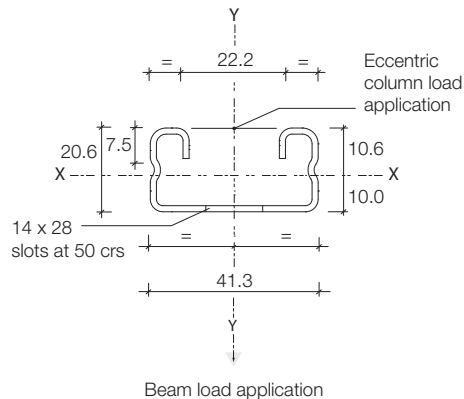

$\frac{\propto Le}{r_{yy}} > 180$