

Cable tray systems

Cover - 90° internal riser

Finish: pre galvanised = **PG**, post galvanised = **HDG**, stainless steel grade 316 = **SS**
 Standard closed covers = **CC**, ventilated cover = **CV**
 Includes 8 fixing clamps and fasteners

| Width mm | Light duty | Medium duty | Heavy duty |
|----------|-------------------|-------------------|-------------------|
| 50 | CTIR12CV/0050PG90 | CTIR25CC/0050PG90 | N/A |
| 75 | CTIR12CV/0075PG90 | CTIR25CC/0075PG90 | CTIR50CC/0075PG90 |
| 100 | CTIR12CV/0100PG90 | CTIR25CC/0100PG90 | CTIR50CC/0100PG90 |
| 150 | CTIR12CV/0150PG90 | CTIR25CC/0150PG90 | CTIR50CC/0150PG90 |
| 225 | CTIR12CV/0225PG90 | CTIR25CC/0225PG90 | CTIR50CC/0225PG90 |
| 300 | CTIR18CV/0300PG90 | CTIR25CC/0300PG90 | CTIR50CC/0300PG90 |
| 450 | N/A | CTIR25CC/0450PG90 | CTIR50CC/0450PG90 |
| 600 | N/A | CTIR25CC/0600PG90 | CTIR50CC/0600PG90 |
| 750 | N/A | N/A | CTIR50CC/0750PG90 |
| 900 | N/A | N/A | CTIR50CC/0900PG90 |

*NB. Closed cover not available for 12mm and 18mm deep cable tray.

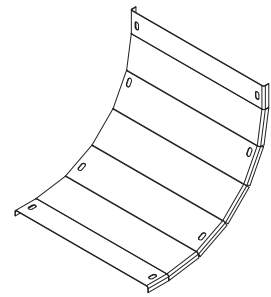

Cover - 90° external riser

Finish: pre galvanised = **PG**, post galvanised = **HDG**, stainless steel grade 316 = **SS**
 Standard closed covers = **CC**, ventilated cover = **CV**
 Includes 8 fixing clamps and fasteners

| Width mm | Light duty | Medium duty | Heavy duty |
|----------|-------------------|-------------------|-------------------|
| 50 | CTER12CV/0050PG90 | CTER25CC/0050PG90 | N/A |
| 75 | CTER12CV/0075PG90 | CTER25CC/0075PG90 | CTER50CC/0075PG90 |
| 100 | CTER12CV/0100PG90 | CTER25CC/0100PG90 | CTER50CC/0100PG90 |
| 150 | CTER12CV/0150PG90 | CTER25CC/0150PG90 | CTER50CC/0150PG90 |
| 225 | CTER12CV/0225PG90 | CTER25CC/0225PG90 | CTER50CC/0225PG90 |
| 300 | CTER18CV/0300PG90 | CTER25CC/0300PG90 | CTER50CC/0300PG90 |
| 450 | N/A | CTER25CC/0450PG90 | CTER50CC/0450PG90 |
| 600 | N/A | CTER25CC/0600PG90 | CTER50CC/0600PG90 |
| 750 | N/A | N/A | CTER50CC/0750PG90 |
| 900 | N/A | N/A | CTER50CC/0900PG90 |

*NB. Closed cover not available for 12mm and 18mm deep cable tray.

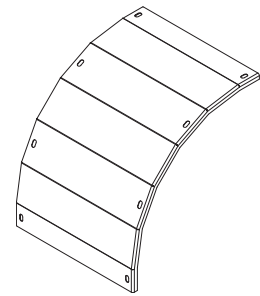

Stand off brackets

Finish: pre galvanised = **PG**, post galvanised = **HDG**, stainless steel grade 316 = **SS**

| Width mm | |
|----------|-----------|
| 50 | CTSO050PG |
| 75 | CTSO075PG |
| 100 | CTSO100PG |
| 150 | CTSO150PG |
| 225 | CTSO225PG |
| 300 | CTSO300PG |
| 450 | CTSO450PG |
| 600 | CTSO600PG |
| 750 | CTSO750PG |
| 900 | CTSO900PG |

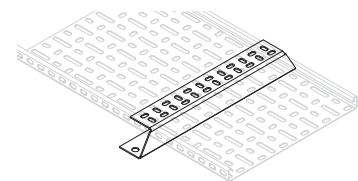
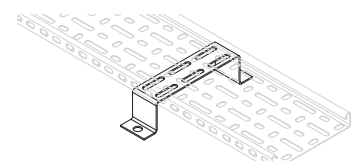

Hanger brackets

Finish: pre galvanised = **PG**, post galvanised = **HDG**, stainless steel grade 316 = **SS**

| Width mm | |
|-------------|------------|
| 50 | CTHB050/PG |
| 75 | CTHB075/PG |
| 100 | CTHB100/PG |
| 150 | CTHB150/PG |

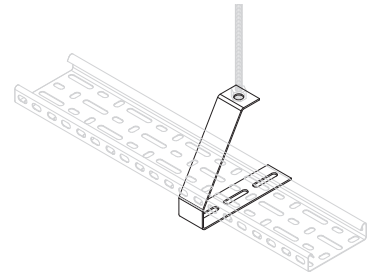

Straight divider - 3m

Finish: pre galvanised = **PG**, post galvanised = **HDG**, stainless steel grade 316 = **SS**

| Tray depth mm | |
|------------------|------------|
| 25 | CTDI025PG3 |
| 50 | CTDI050PG3 |

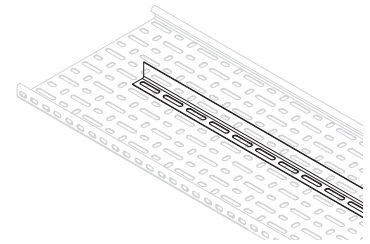

Earthing straps

Finish: electro-tinned

| | |
|---|-------------------------|
| Use M6 x 12 roofing bolts | Supplied in packs of 10 |
| CT/ES100 | |
| Copper braid electro tinned 4mm ² , 100mm long | |

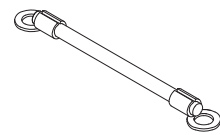

Roofing bolts and nuts

Finish: BZP as standard, stainless steel grade 316 = **SS**

| |
|--------------------------|
| M6 x 12 roofing bolts |
| Supplied in packs of 100 |
| M06X12RB |

